

☐

I'm not robot

  
reCAPTCHA

Continue

Gravely zt 42 xl service manual

Gravely zt xl 42 dimensions. Gravely zt xl 42 maintenance schedule. Changing oil on gravely zt xl 42.

SPRING SALE! 10% Off + Free Shipping - All Online Parts & Accessories Orders Shop Now Sponsored Advertisements: ZT XL™ Owner/Operator Manual Manuel du Propriétaire/Utilisateur Models 915160 – ZT XL 42 (SN 030000 +) 915162 – ZT XL 48 (SN 030000 +) 915164 – ZT XL 54 (SN 030000 +) 915184 – ZT XL 42 (SN 030000 +) 915186 – ZT XL 48 (SN 030000 +) 915188 – ZT XL 54 (SN 030000 +) The use of any gasoline exceeding 10% ethanol (E10) or E10 10% MTBE will void the product warranty. L'utilisation d'une essence contenant plus de 10% d'éthanol (E10) ou de 10% de MTBE annulent la garantie. ENGLISH FRANÇAIS 04699600D • 6/14 Printed in USA TABLE OF CONTENTS SAFETY. ....



4 ASSEMBLY

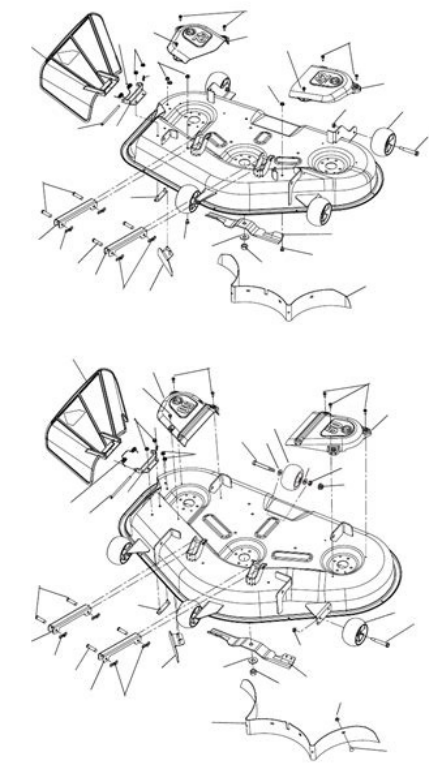

11 CONTROLS AND FEATURES ..... 13 OPERATION .....  
14 MAINTENANCE SCHEDULE .  
18 SERVICE AND ADJUSTMENTS ..... 20 STORAGE .







**ZT**

**Owner/Operator Manual**

**Models**

915160 - 1754  
915162 - 2040  
915164 - 2050  
915166 - 2060  
915168 - 2080

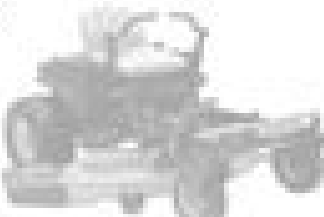

.....  
..... 27 TROUBLESHOOTING .....

..... 28 SERVICE PARTS .....

..... 30 ACCESSORIES. ....

..... 30 SPECIFICATIONS. ....

..... 31 WARRANTY .....

.....  
..... 33 INTRODUCTION MANUALES EN IDIOMAS DIFERENTES DEL INGLES Puede obtener manuales en idiomas diferentes del inglés en su distribuidor. Visite a su distribuidor o vaya a [www.ariensgravely.com](http://www.ariensgravely.com) para obtener una lista de idiomas disponibles para su equipo. También puede imprimir manuales en idiomas diferentes del inglés descargándolos gratuitamente de nuestra página Web: THE MANUAL Before operation of unit, carefully and completely read your manuals. The contents will provide you with an understanding of safety instructions and controls during normal operation and maintenance. All reference to left, right, front, or rear are given from operator seated in operation position and facing the direction of forward travel. They are printed on a serial number label, located on the frame of your unit. See Figure 1. Unit Serial Number Label Figure 1 •Record unit model and serial numbers here. ENGINE MANUAL The engine on this unit is covered by a separate manual specific to the engine. This manual is included in the literature package that shipped with the unit. Refer to this manual for engine service recommendations. If the engine manual is not available, contact the engine manufacturer for a replacement manual. MODEL AND SERIAL NUMBERS When ordering replacement parts or making service inquiries, know the Model and Serial numbers of your unit and engine. Numbers are located on the product registration form in the unit literature package. •Record engine model and serial numbers here. PRODUCT REGISTRATION The Gravely dealer must register the product at the time of purchase. Registering the product will help the company process warranty claims or contact you with the latest service information. All claims meeting requirements during the limited warranty period will be honored, whether or not the product registration card is returned. Keep a proof of purchase if you do not register your unit. Customer Note: If the dealer does not register your product, please fill out, sign, and return the product registration card to Gravely. UNAUTHORIZED REPLACEMENT PARTS Use only Gravely replacement parts. The replacement of any part on this unit with anything other than a Gravely authorized replacement part may adversely affect the performance, durability, and safety of this unit and may void the warranty. Gravely disclaims liability for any claims or damages, whether warranty, property damage, personal injury or death arising out of the use of unauthorized replacement parts.

DELIVERY Customer Note: If you have purchased this product without complete assembly and instruction by your retailer, it is your responsibility to: •Read and understand all assembly instructions in this manual. If you do not understand or have difficulty following the instructions, contact your nearest Gravely Dealer for assistance. NOTICE: To locate your nearest Ariens Dealer, go to [www.ariens.com](http://www.ariens.com) on the Internet.

NOTICE: To locate your nearest Gravely Dealer, go to [www.gravely.com](http://www.gravely.com) on the Internet. WARNING: Improper assembly or adjustments can cause serious injury. Before Attempting To Operate Your Unit: 1.Make sure all assembly has been properly completed. 2.Understand all Safety Precautions provided in the manuals. 3.Review control functions and operation of the unit. Do not operate the unit unless all controls function as described in this manual. 4.Review recommended lubrication, maintenance and adjustments. 5.Review Limited Warranty Policy. 6.Fill out a product registration card and return the card to the Gravely Company or go to [www.gravely.com](http://www.gravely.com). DISCLAIMER Gravely reserves the right to discontinue, change, and improve its products at any time without notice or obligation to the purchaser. The descriptions and specifications contained in this manual were in effect at printing. Equipment described within this manual may be optional. Some illustrations may not be applicable to your unit. SAFETY WARNING: This cutting machine is capable of amputating hands and feet and throwing objects. Failure to observe the safety instructions in the manuals and on decals could result in serious injury or death. Slopes are a major factor related to loss-of-control and tip-over accidents. Operation on all slopes requires extra caution. Tragic accidents can occur if the operator is not alert to the presence of children. Never assume that children will remain where you last saw them. Gasoline is extremely flammable and the vapors are explosive, handle with care. Disengage attachment, stop unit and engine, remove key, engage parking brake, and allow moving parts to stop before leaving operator's position. SAFETY ALERTS Look for these symbols to point out important safety precautions. They mean: •Attention! •Personal Safety Is Involved! •Become Alert! •Obey The Message! The safety alert symbol is used in decals and with this manual. Understand the safety message. It contains important information about personal safety. DANGER: IMMINENTLY HAZARDOUS SITUATION! If not avoided, WILL RESULT in death or serious injury. WARNING: POTENTIALLY HAZARDOUS SITUATION! If not avoided, COULD RESULT in death or serious injury. CAUTION: POTENTIALLY HAZARDOUS SITUATION! If not avoided, MAY RESULT in minor or moderate injury. It may also be used to alert against unsafe practices. NOTATIONS NOTICE: General reference information for proper operation and maintenance practices. IMPORTANT: Specific procedures or information required to prevent damage to unit or attachment. SAFETY DECALS AND LOCATIONS ALWAYS replace missing or damaged Safety Decals. Refer to Figure 2 for safety decal locations. 1 07800401 4

5 6 KEEP HANDS and FEET AWAY 2 3 P 07800403 Figure 2 1. DANGER! 2. DANGER! Discharge Hazard – Discharge Hazard - NEVER operate unit NEVER direct discharge without discharge chute toward people, pets or in operating position. property. Thrown objects Thrown objects can can cause injury or cause injury or damage. damage. Do not operate mower Dismemberment Hazard – unless all guards are in operating position.

Thrown objects can cause injury or damage. Do not operate mower unless all guards are in operating position or bagger is attached. 4. DANGER! DANGER! Read and understand the operator's manual before operating unit. 4.1 Dismemberment Hazard To avoid dismemberment hazard do not put hands near rotating blades. To avoid dismemberment hazard do not put hands near moving belts. Keep hands away from all rotating or moving parts. Keep all guards and shields in place. 4.2 Discharge Hazard Discharge Hazard – NEVER direct discharge toward people, pets or property. Thrown objects can cause injury or damage.

4.3 Tipping Hazard Avoid tipping hazard. DO NOT operate on slopes over 15°. If loss of traction is experienced do the following: 4.4 Service Hazard Before servicing unit do the Disengage PTO. following: Read owners manual Look before backing, before servicing or making Proceed off slope slowly. adjustments to unit. Set parking brake. Do not try to turn or speed up. Remove key and 5. HOT SURFACES! disconnect spark plug before servicing or making adjustments to unit.

DO NOT touch parts which are hot from 4.5 Bystander Hazard operation. ALWAYS allow parts to cool. DO NOT operate the unit in the presence of 6. DANGER! bystanders. Keep hands and feet away. Do not carry passengers. EMISSION CONTROL SYSTEM Look behind when This equipment and/or its engine may include exhaust and evaporative emissions control operating the unit in system components required to meet U.S. reverse.

Environmental Protection Agency (EPA) and/or California Air Resources Board (CARB) regulations. Tampering with emission controls and components by unauthorized personnel may result in severe fines or penalties. Emission controls and components can only be adjusted by an Ariens Company EN - 7 dealer or an authorized engine manufacturer's service center. Contact your Ariens Company Equipment Retailer concerning emission controls and component questions. SAFETY RULES If unit is to be used by someone other than original purchaser; loaned, rented or sold, ALWAYS provide this manual and any needed safety training before operation.

Only the user can prevent and is responsible for accidents or injuries occurring to themselves, other people or property. Read, understand, and follow all safety practices in Owner/Operator Manual before assembling, using or working on this mower. ALWAYS remove key from ignition and wire from spark plug before assembly, or working on this unit. ALWAYS be aware of traffic when crossing or operating along streets or curbs. Keep children, people, and pets away. Be alert and shut off unit if anyone enters work area. Keep children under watchful care of a responsible adult. NEVER allow children to operate or play on or near unit. Keep area of operation clear of all toys, and debris. Thrown

objects can cause injury. Stay alert for hidden hazards, holes, and ruts. Avoid uneven or rough terrain. DO NOT operate near drop-offs, ditches, or embankments. Unit can suddenly turn over if a wheel is over the edge of a cliff or ditch, or if an edge caves in. Dust, fog, etc. can reduce vision and cause an accident. Operate unit only when there is good visibility and light.

Data indicates that operators, age 60 and above, are involved in a larger percentage of riding mower related injuries. These operators should evaluate their ability to operate the riding mower safely enough to protect themselves and others from serious injury. Wear adequate safety gear, sturdy shoes, and protective gloves. Only trained adults may operate unit.

Training includes being familiar with controls and actual operation. NEVER operate unit after or during the use of medication, drugs or alcohol. NEVER allow anyone to operate this unit when their alertness or coordination is impaired. DO NOT wear loose clothing or jewelry and tie back hair that may get caught in rotating parts.

Know the weight of loads. Limit loads to those you can safely control and the unit can safely handle. ALWAYS keep protective structures, guards and panels in good repair, in place and securely fastened. Do not operate without either entire grass catcher or the discharge guard in place. DO NOT operate in reverse unless absolutely necessary. ALWAYS look down and behind before and while backing; especially for children. Follow the manufacturer's recommendations for wheel weights or counterweights to improve stability when using attachments. NEVER carry passengers – especially children – even with blades off. Use extra care when approaching blind corners or objects that may obscure vision of hidden obstacles and children. If you cannot back up a slope or you feel uneasy on it, do not mow it. Operation on slopes may lead to loss of steering control. When operating on slopes be prepared to react to an emergency situation: •Return steering levers to neutral position. •Immediately set parking brake. •Turn off PTO and engine. Mow up and down slopes, not across them. Use slow speed on any slope. Tires may lose traction on slopes even though the brakes are functioning properly. Keep all movements on the slope slow and gradual. DO NOT make sudden changes in speed or direction. Use extra care while operating machines with grass catcher or other attachments. They can affect stability of the machine. Avoid starting, stopping, or turning on a slope. If tires lose traction, disengage the blades and proceed slowly straight down the slope. DO NOT operate on slopes over 15°. DO NOT park on slopes unless necessary. If unit is parked on a slope, ALWAYS chock or block wheels and set parking brake. DO NOT disengage or bypass transmission and coast downhill. Tow only with a machine that has a hitch designed for towing. Do not attach towed equipment except at the hitch point. Follow the manufacture's recommendations for weight limits for towed equipment and towing on slopes.

NEVER allow children or others in or on towed equipment. On slopes, the weight of the towed equipment may cause loss of traction and loss of control. Travel slowly and allow extra distance to stop. Use extra care when loading or unloading unit onto trailer or truck. Secure unit chassis to transport vehicle. NEVER secure from rods or linkages that could be damaged. DO NOT transport machine while engine is running. ALWAYS turn off power to attachment and shut off fuel when transporting unit. Keep unit free of grass clippings, leaves, and other debris.

Clean up oil or fuel spills. This product is equipped with an internal combustion type engine. DO NOT use unit on or near any unimproved, forest-covered or brush covered land unless exhaust system is equipped with a spark arrester meeting applicable local, state or federal laws. A spark arrester, if it is used, must be maintained in effective working order by operator. Fuel is highly flammable and its vapors are explosive. Handle with care. Use only an approved gasoline container with an appropriately sized dispensing spout. NO smoking, NO sparks, NO flames.

ALWAYS allow engine to cool before servicing. NEVER fill fuel tank when engine is running or hot from operation. NEVER fill or drain fuel tank indoors. NEVER overfill fuel tank. Replace fuel cap securely and clean up spilled fuel. NEVER fill containers inside a vehicle or on a truck or trailer bed with a plastic liner. Always place containers on the ground away from your vehicle before filling. When practical, remove gas-powered equipment from the truck or trailer and refuel it on the ground. If this is not possible, then refuel such equipment on a trailer with a portable container, rather than from a gasoline dispenser nozzle. Keep the nozzle in contact with the rim of the fuel tank or container opening at all times until fueling is complete. Do not use a nozzle lockopen device. If fuel is spilled on clothing, change clothing immediately. Avoid Electric Shock. Objects contacting both battery terminals at the same time may result in injury and unit damage. DO NOT reverse battery connections. Explosive Gases from battery can cause death or serious injury. Poisonous battery fluid contains sulfuric acid and its contact with skin, eyes or clothing can cause severe chemical burns. NO flames, NO sparks, NO smoking near battery. ALWAYS wear safety glasses and protective gear near battery. Use insulated tools. Battery posts, terminals and related accessories contain lead and lead compounds, chemicals known to the State of California to cause cancer and reproductive harm. Wash hands after handling. ALWAYS keep batteries out of reach of children. Reverse connections may result in sparks which can cause serious injury. Always connect positive (+) lead of charger to positive (+) terminal, and negative (-) lead to negative (-) terminal.

ALWAYS disconnect negative (-) cable FIRST and positive (+) cable SECOND. ALWAYS connect positive (+) cable FIRST, and negative (-) cable SECOND. A frozen battery can explode and result in death or serious injury. DO NOT charge or jump start a battery containing frozen fluid. Thaw the battery before putting on a charger or jump starting. ALWAYS keep protective structures, guards, and panels in good repair, in place and securely fastened. NEVER modify or remove safety devices. DO NOT change engine governor settings or over-speed engine. Fumes from engine exhaust can cause injury or death. DO NOT run engine in an enclosed area. Always provide good ventilation.ALWAYS maintain unit in safe operating condition. Damaged or worn out muffler can cause fire or explosion. Stop and inspect equipment if you strike an object or if there is an unusual vibration.

Repair, if necessary, before restarting. Never make adjustments or repairs with the engine running. Mower blades are sharp and can cut you. Wrap the blade(s) or wear gloves, and use extra caution when servicing them. NEVER weld or straighten mower blades. Rotation of one blade may cause rotation of the other blades. Check brake operation frequently. Adjust and service as required. Keep all hardware properly tightened. Stored energy in springs can cause injury. Maintain or replace safety and instruction labels, as necessary. Never store the machine or fuel container inside a building where there is an open flame, such as a water heater. Shut off fuel (if provided) and allow engine to cool completely before storing in closed area or covering unit. Clean grass and debris from unit, especially from around muffler and engine, to help prevent fires. For extended storage, clean unit thoroughly. See Engine Manual for proper storage. Use only attachments or accessories designed for your unit. Check attachment components frequently.

If worn or damaged, replace with manufacturer's recommended parts. ASSEMBLY WARNING: AVOID INJURY. Read and understand the entire Safety section before proceeding. Tools Required •Adjustable wrench •9/16" wrench •Petroleum jelly or dielectric grease. Unpack Unit Remove unit and all other components from the shipping container. Engage transmission bypass lever (see MOVING UNIT MANUALLY on page 17). Push unit from container onto a level surface. Disengage transmission bypass lever. Connect Battery See Battery Removal and Installation on page 22 and perform steps 4 and 5 in the installation section. Place Unit in Operating Position Figure 3 NOTICE: The seat is shipped with the seat positioned as far back as possible. 1.Push steering levers aside and tip seat up. 2.Adjust the seat as needed (see Adjusting Seat on page 16). 3.Remove hardware from top hole of the steering lever Figure 3. Slide steering lever back to align slot with hole at the top of the steering pivot arm. NOTICE: Do not tighten hardware

before reviewing ADJUSTING STEERING LEVERS on page 24. If no adjustment is desired tighten hardware. 4.Adjust steering levers (see ADJUSTING STEERING LEVERS on page 24). 1 3 2 1.Steering Lever 2.Steering Pivot Arm 3.Steering Lever Hardware Figure 3 Place Discharge Chute in Operating Position WARNING: Do not operate mower unless the discharge chute is in the operating position. Prior to operating the unit, remove the discharge chute from the transport position and place the discharge chute in the operating position (Figure 4). 1.Remove and discard the nuts holding the discharge chute in transport position. 2.Remove the plastic knobs from the chute hardware and use to mount the chute to the deck in operating position. See Figure 4.

User Manual: Ariens Lawn Mower 915160 GRAVELY ZT XL 42 Open the PDF directly: View PDF .Page Count: 3 Directly view this document at